



PIVOT PUNCH CORPORATION / BALL LOCK

Heavy Duty/Light Duty

TRUE[®] POSITION Retainers

...The interchangeable retainer that is the industry standard

Benefits:

- Precise punch-to-bushing alignment assured with the in-line dowel feature. Reduces downtime, produces higher quality and maximizes punch life.
- Mounting time is reduced by 45%, no more hand lifting. Simply pull a True Position Retainer from its box and screw it to the die set. True Position retainers are dimensionally accurate every time.
- Only one dowel is required for round punches which reduces machining time by 50%.
- The precision ground ball hole assures the precise alignment of shaped punches, even if the retainer is replaced.
- There is complete interchangeability between Heavy Duty and Light Duty retainers in the event of an engineering change.
- Cuts inventory in half

**True Position[®]
Retainer Sets Include:**

- 1 Ball 1 Spring
- 2 Screws 2 Dowels
- 1 Ball Release Set Screw



How to Order:

Qty	Type	D
23	HRT	37
13	LRT	62

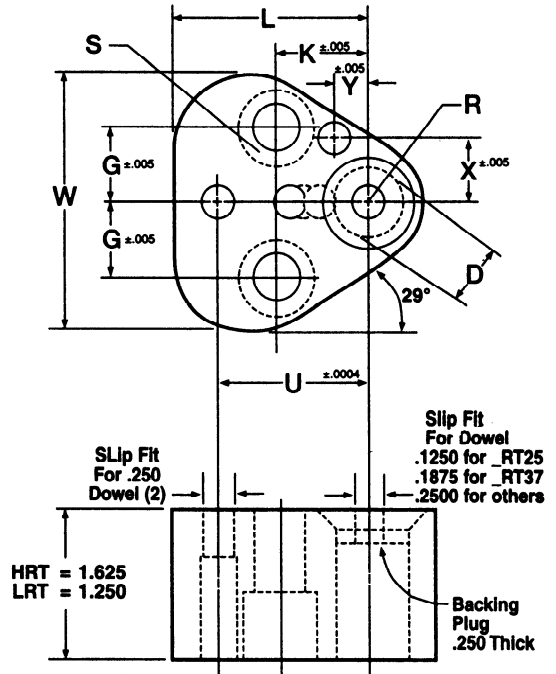

Catalog Number

Heavy Duty	Light Duty	Code	D	G	K	L	R	S	U	W	See Note Above		Screw Size
											X	Y	
-	LRT	25	.2500	.438	.750	1.38	.38	.47	1.060	1.72	.354	.295	5/16-18
HRT	LRT	37	.3750	.438	.750	1.38	.38	.47	1.060	1.72	.354	.295	5/16-18
HRT	LRT	50	.5000	.562	.750	1.50	.50	.60	1.180	1.97	.472	.256	3/8-16
HRT	LRT	62	.6250	.625	.750	1.56	.56	.66	1.250	2.09	.532	.236	3/8-16
HRT	LRT	75	.7500	.688	.750	1.69	.69	.79	1.320	2.34	.650	.197	3/8-16
HRT	LRT	87	.8750	.688	.750	1.75	.75	.85	1.400	2.47	.728	.197	3/8-16
HRT	LRT	100	1.0000	.781	.938	1.88	.88	.97	1.600	2.72	.866	.276	1/2-13
HRT	-	125	1.2500	.781	.938	1.88	.88	.97	1.600	2.72	.866	.276	1/2-13

MANUFACTURED BY DAYTON PROGRESS CORPORATION

[®]TRUE POSITION, TRUE SHAPE, TRUE POSITION BACKING PLUG DESIGN AND TRILITERAL DESIGNATORS ARE REGISTERED TRADEMARKS OF DAYTON PROGRESS CORPORATION.