

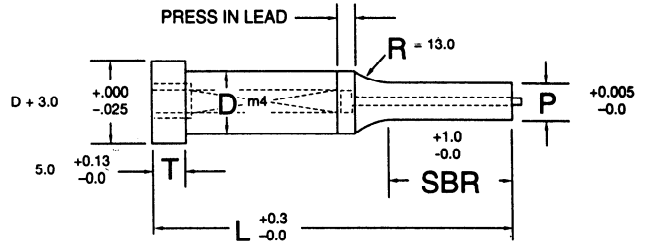

PIVOT PUNCH CORPORATION / SELECTIVE SERIES METRIC  
**EJECTOR PUNCH**

STEEL: M-2 R/C 60/62  
HEADS DRAWN TO R/C 40-50

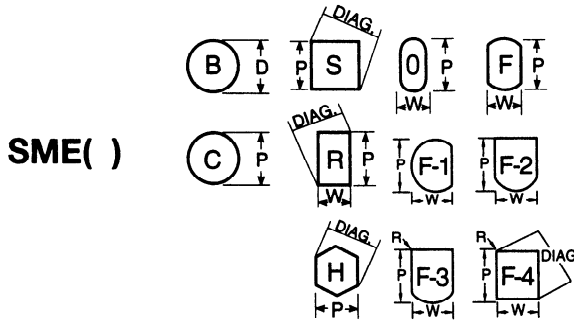

Selective Tol. 1 Round & Shape +0.005 -0.0 T.I.R. = 0.008

D	SBR	Round	Shape	Length = L									
		Range P	Min. W Max. DIAG.	40.0	45.0	50.0	56.0	60.0	63.0	71.0	80.0	90.0	100.0
05	8.0	1.60- 4.99	1.60- 5.00	4008	4508	5008	5608	6008	6308	7108	8008	9008	10008
06		2.40- 5.99	2.40- 6.00										
05	13.0	1.60- 4.99	1.60- 5.00										
06		2.40- 5.99	2.40- 6.00										
08		3.20- 7.99	3.20- 8.00										
10		4.50- 9.99	4.50-10.00										
13		6.00-12.99	6.00-13.00		4513	5013	5613	6013	6313	7113	8013	9013	10013
16		8.00-15.99	7.20-16.00										
20		9.50-19.99	8.00-20.00										
25		12.00-24.99	9.00-25.00										
32	16.00-31.99	10.00-32.00											
05	19.0	1.60- 4.99	1.60-5.00										
06		2.40- 5.99	2.40- 6.00										
08		3.20- 7.99	3.20- 8.00										
10		4.50- 9.99	4.50-10.00										
13		6.00-12.99	6.00-13.00		4519	5019	5619	6019	6319	7119	8019	9019	10019
16		8.00-15.99	7.20-16.00										
20		9.50-19.99	8.00-20.00										
25		12.00-24.99	9.00-25.00										
32	16.00-31.99	10.00-32.00											
06	25.0	2.40- 5.99	2.40- 6.00										
08		3.20- 7.99	3.20- 8.00										
10		4.50- 9.99	4.50-10.00										
13		6.00-12.99	6.00-13.00										
16		8.00-15.99	7.20-16.00				5625	6025	6325	7125	8025	9025	10025
20		9.50-19.99	8.00-20.00										
25		12.00-24.99	9.00-25.00										
32		16.00-31.99	10.00-32.00										

**HOW TO ORDER**

TYPE: SME    SHAPE: R    DIA. CODE: 08    LENGTH: 50    SBR: 19    "P": 5.60    "W": 4.35