

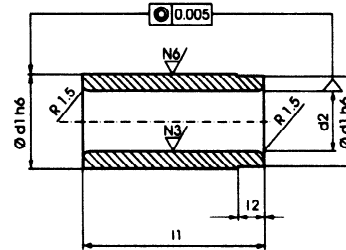

Data:

Miniature linear AGATHON bearing sizes listed below are part of a range which offer diameters up to 100 mm plus.

STEEL BUSHING Norm 780



Art. Nr.	d	d2 x d1 x l1 - l2	Art. Nr.	d	d2 x d1 x l1 - l2	Art. Nr.	d	d2 x d1 x l1 - l2
78005100	3	5 x 8 x 10 - 3	78009150	6	9 x 12 x 15 - 3	78014300	10	14 x 20 x 30 - 5
78005150	3	5 x 8 x 15 - 3	78009200	6	9 x 12 x 20 - 3	78014350	10	14 x 20 x 35 - 5
78005200	3	5 x 8 x 20 - 3	78009250	6	9 x 12 x 25 - 5	78014400	10	14 x 20 x 40 - 5
78006100	4	6 x 8 x 10 - 3	78009300	6	9 x 12 x 30 - 5	78014450	10	14 x 20 x 45 - 5
78006150	4	6 x 8 x 15 - 3	78011200	8	11 x 15 x 20 - 3	78016200	12	16 x 22 x 20 - 3
78006200	4	6 x 8 x 20 - 3	78011250	8	11 x 15 x 25 - 5	78016250	12	16 x 22 x 25 - 5
78007100	5	7 x 10 x 10 - 3	78011300	8	11 x 15 x 30 - 5	78016300	12	16 x 22 x 30 - 5
78007150	5	7 x 10 x 15 - 3	78011350	8	11 x 15 x 35 - 5	78016350	12	16 x 22 x 35 - 5
78007200	5	7 x 10 x 20 - 3	78014200	10	14 x 20 x 20 - 3	78016400	12	16 x 22 x 40 - 5
78007250	5	7 x 10 x 25 - 3	78014250	10	14 x 20 x 25 - 5	78016450	12	16 x 22 x 45 - 5

BALL SLEEVE Norm 765

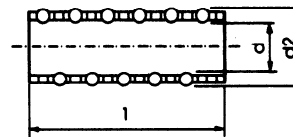

Art. Nr.	d x d2 x l	Art. Nr.	d x d2 x l	Art. Nr.	d x d2 x l
76503100	3 x 5 x 10	76506150	6 x 9 x 15	76510360	10 x 14 x 36
76503150	3 x 5 x 15	76506200	6 x 9 x 20	76510420	10 x 14 x 42
76503200	3 x 5 x 20	76506250	6 x 9 x 25	76510510	10 x 14 x 51
76504100	4 x 6 x 10	76506300	6 x 9 x 30	76512200	12 x 16 x 20
76504150	4 x 6 x 15	76508200	8 x 11 x 20	76512300	12 x 16 x 30
76504200	4 x 6 x 20	76508300	8 x 11 x 30	76512360	12 x 16 x 36
76505100	5 x 7 x 10	76508360	8 x 11 x 36	76512420	12 x 16 x 42
76505150	5 x 7 x 15	76508410	8 x 11 x 41	76512510	12 x 16 x 51
76505200	5 x 7 x 20	76510210	10 x 14 x 21		
76505250	5 x 7 x 25	76510300	10 x 14 x 30		

PILLAR Norm 650

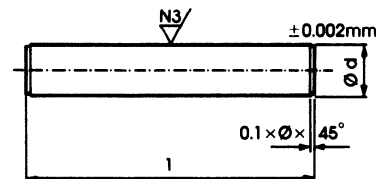

Art. Nr.	d x l	Art. Nr.	d x l	Art. Nr.	d x l	Art. Nr.	d x l
65003030	3 x 30	65005030	5 x 30	65006120	6 x 120	65010120	10 x 120
65003040	3 x 40	65005040	5 x 40	65008040	8 x 40	65010140	10 x 140
65003050	3 x 50	65005050	5 x 50	65008050	8 x 50	65010160	10 x 160
65003060	3 x 60	65005060	5 x 60	65008060	8 x 60	65012060	12 x 60
65003080	3 x 80	65005070	5 x 70	65008080	8 x 80	65012070	12 x 70
65004030	4 x 30	65005080	5 x 80	65008100	8 x 100	65012080	12 x 80
65004040	4 x 40	65005100	5 x 100	65008120	8 x 120	65012100	12 x 100
65004050	4 x 50	65006040	6 x 40	65008140	8 x 140	65012120	12 x 120
65004060	4 x 60	65006050	6 x 50	65010050	10 x 50	65012140	12 x 140
65004070	4 x 70	65006060	6 x 60	65010060	10 x 60	65012160	12 x 160
65004080	4 x 80	65006080	6 x 80	65010080	10 x 80	65012180	12 x 180
65004100	4 x 100	65006100	6 x 100	65010100	10 x 100		