

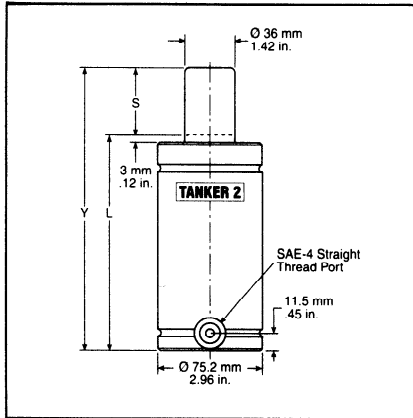

T2B-1500 (3") DIAMETER GAS SPRINGS



Product Specifications:

- Pressure Medium Nitrogen Gas
- Charging Pressure Range Max.: 150 bar/2175 psi
Min.: 50 bar/725 psi
- Maximum Gas Spring Operating Temperature 80 C°/176 F°
- Maximum Piston Rod Velocity 35m/min
115 ft./min
- Maximum Utilized Stroke 100%
- Seal Kit Number Part No.: T2SK-1500
- Male Quick Disconnect (Charge Fitting) Part No.: T2-770-4

T2B-1500 Stroke Lengths									
Model	x	Stroke in	Contact Force lb _f	Full Stroke Force lb _f	L in	Y in	D in	E in	Gas Volume in ³
T2B-1500	x .5		3430	5010	4.50	5.00	3.36	1.64	2.50
T2B-1500	x 1		3430	5040	5.00	6.00	3.86	2.14	4.93
T2B-1500	x 1.5		3430	5040	5.50	7.00	4.36	2.64	7.40
T2B-1500	x 2		3430	5080	6.00	8.00	4.86	3.14	9.73
T2B-1500	x 2.5		3430	5080	6.50	9.00	5.36	3.64	12.16
T2B-1500	x 3		3430	5080	7.00	10.00	5.86	4.14	14.59
T2B-1500	x 3.5		3430	5080	7.50	11.00	6.36	4.64	17.03
T2B-1500	x 4		3430	5210	8.00	12.00	6.86	5.14	18.45
T2B-1500	x 4.5		3430	5180	8.50	13.00	7.36	5.64	21.02
T2B-1500	x 5		3430	5180	9.00	14.00	7.86	6.14	23.36
T2B-1500	x 5.5		3430	5180	9.50	15.00	8.36	6.64	25.69
T2B-1500	x 6		3430	5180	10.00	16.00	8.86	7.14	28.03

NOTE: Charted force values are based on 150bar/2175 psi charge. Please contact Customer Service for optional stroke lengths. Old P/N = T2-15/T2B-15

Force Calculations:

Select desired Model x Stroke

Pressure Rise for stroke used:

$$\text{Pressure Rise} = \frac{\text{Gas Volume (mm}^3\text{)}}{\text{Gas Volume (mm}^3\text{)} - [1018 \text{ mm}^2 \times \text{Stroke Used (mm)]}$$

$$\text{Pressure Rise} = \frac{\text{Gas Volume (in}^3\text{)}}{\text{Gas Volume (in}^3\text{)} - [1.58 \text{ in}^2 \times \text{Stroke Used (in.)}]}$$

Force at stroke used:

$$\text{Force (N)} = \frac{\text{Pressure Rise} \times \text{Charge Pressure (bar)}}{0.0098}$$

$$\text{Force (lb}_f\text{)} = \frac{\text{Pressure Rise} \times \text{Charge Pressure (lb/in}^2\text{)}}{0.63}$$

Ordering Example:

T2B-1500 x 2.5 - FM - 2175

Model x Stroke (See charts) Charge Pressure
Mounting & Counterbore Option

Shipped charged at 150 bar/2175 psi, unless otherwise specified. Metric (M) and English (E) mounting threads available upon request. Specify mount counterbore for LM, FM & SF style mounts.

All dimensions are nominal unless tolerance is stated.

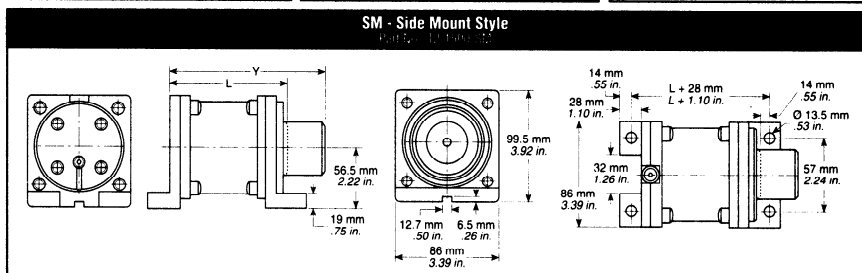
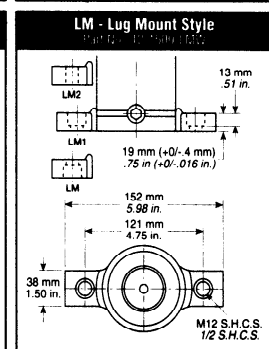
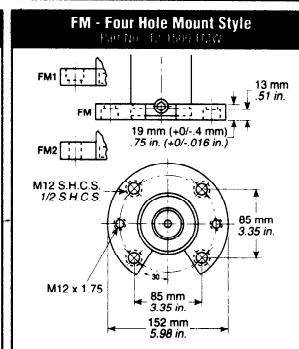
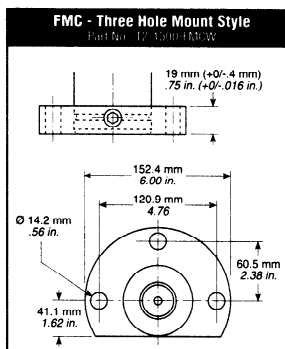
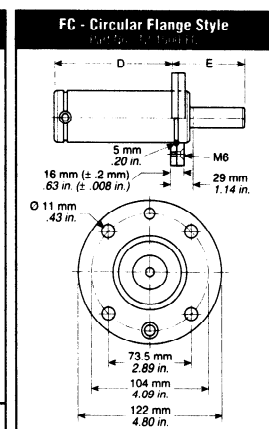
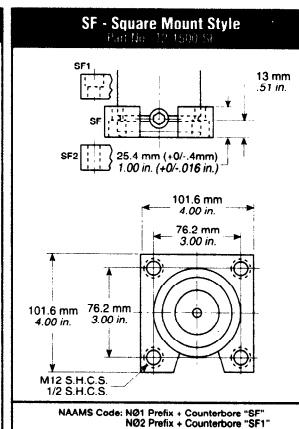
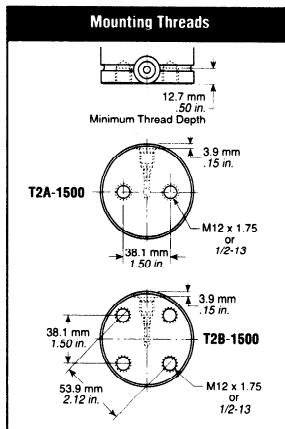

NOTE: Teledyne Fluid Systems, Hyson Products recommends that all Tanker 2 gas springs are backed up at all times. All dimensions are nominal unless tolerance is stated.