



PIVOT PUNCH CORPORATION / BASIC SERIES
SOLID PUNCHES

STEEL: A2, M2 R/C 60-62
HEADS DRAWN TO R/C 40-50

AS()

A-2 STEEL

HS()

M-2 STEEL

YS()

M-2 STRAIGHT
GRIND

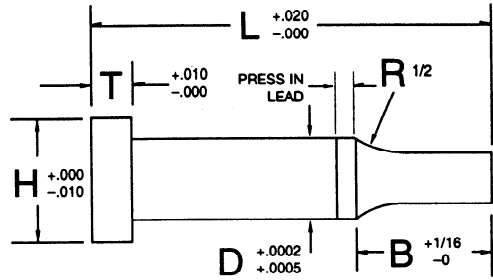
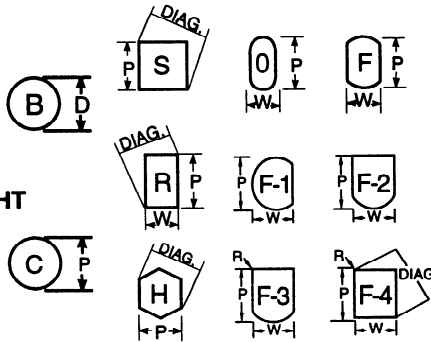

ROUND

TOL. #1	TOL. #2
+0.005 -0.000	+0.005 -0.005
T•I•R .005	T•I•R .001

SHAPE

TOL. #1	TOL. #2
±0.005	±0.001
T•I•R .001	T•I•R .002

UNIVERSAL CODE: 1001 (SEE PAGE 175)

Shank		Head Dim.		Point Length B					Round		Shape		Overall Length L									
D	Code	H	T	NAPMA		Alternate			Min. SP	Range P	Min. SW	Min. Max. W DIAG.	1.50	1.75	2.00	2.25	2.50	2.75	3.00	3.50	4.00	
.1875	18	.312	.125	.43	.75				.042	.062-.1875	.062	.062-.1875	X	X	X	X	X					
.2500	25	.375	.125	.50	.75				.062	.062-.2500	.062	.062-.2500	X	X	X	X	X					
.3125	31	.438	.125	.56	.75	1.00*			.062	.093-.3125	.062	.093-.3125	X	X	X	X	X	X				
.3750	37	.500	.188	.62	.75	1.00	1.25**		.062	.125-.3750	.080	.125-.3750	X	X	X	X	X	X	X			
.5000	50	.625	.188	.81		1.00	1.25		.125	.187-.5000	.125	.187-.5000			X	X	X	X	X	X		
.6250	62	.750	.250	.93			1.25	1.50***	.235	.375-.6250	.235	.250-.6250			X	X	X	X	X	X	X	
.7500	75	.875	.250	1.06			1.25	1.50	.300	.500-.7500	.235	.312-.7500			X	X	X	X	X	X	X	X
1.0000	100	1.125	.250	1.25				1.50	.400	.687-1.0000	.235	.375-1.0000			X	X	X	X	X	X	X	X

*NOT AVAILABLE ON 1.50 OVERALL LENGTH
**NOT AVAILABLE ON 1.75 OVERALL LENGTH
***NOT AVAILABLE ON 2.00 OVERALL LENGTH

MIN. SP, SW APPLIES TO S POINT LENGTH

HOW TO ORDER

TYPE D L B P
HSC 37 2.5 S .250

EJECTOR PUNCHES

AE()

A-2 STEEL

HE()

M-2 STEEL

YE()

M-2 STRAIGHT
GRIND

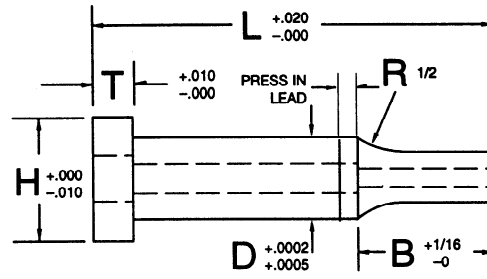
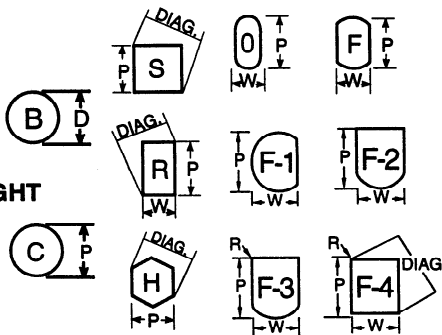

ROUND

TOL. #1	TOL. #2
+0.005 -0.000	+0.005 -0.005
T•I•R .005	T•I•R .001

SHAPE

TOL. #1	TOL. #2
±0.005	±0.001
T•I•R .001	T•I•R .002

UNIVERSAL CODE: 1002 (SEE PAGE 175)

Shank		Head Dim.		Point Length B					Round		Shape		Overall Length L									
D	Code	H	T	NAPMA		Alternate			Min. SP	Range P	Min. SW	Min. Max. W DIAG.	1.50	1.75	2.00	2.25	2.50	2.75	3.00	3.50	4.00	
.1875	18	.312	.125	.43	.75				.050	.062-.1875	.062	.062-.1875	X	X	X	X	X					
.2500	25	.375	.125	.50	.75				.080	.093-.2500	.080	.093-.2500	X	X	X	X	X					
.3125	31	.438	.125	.56	.75	1.00*			.115	.125-.3125	.115	.125-.3125	X	X	X	X	X	X				
.3750	37	.500	.188	.62	.75	1.00			.158	.187-.3750	.158	.187-.3750		X	X	X	X	X	X			
.5000	50	.625	.188	.81		1.00			.158	.250-.5000	.158	.187-.5000			X	X	X	X	X	X		
.6250	62	.750	.250	.93			1.25		.235	.375-.6250	.235	.250-.6250			X	X	X	X	X	X	X	
.7500	75	.875	.250	1.06			1.25		.300	.500-.7500	.235	.312-.7500			X	X	X	X	X	X	X	X
1.0000	100	1.125	.250	1.25				1.50	.400	.687-1.0000	.235	.375-1.0000			X	X	X	X	X	X	X	X

*NOT AVAILABLE ON 1.50 OVERALL LENGTH

MIN. SP, SW APPLIES TO S POINT LENGTH

HOW TO ORDER

TYPE D L B P
HEC 50 3 C .375