

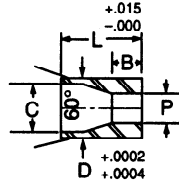

PIVOT PUNCH CORPORATION / SELECTIVE SERIES  
**GUIDE BUSHINGS**

STEEL A2 R/C 60-62

**ACG**  
**A()GW**  
HEADLESS



**ACB**  
**A()BW**  
HEAD DOWN

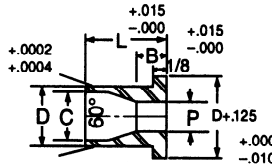

TOLERANCE	
#1	#2
+ .0002 - .0000	+ .0004 - .0000
TIR .0003	TIR .0004

**ACT**  
**A()TW**  
HEAD UP

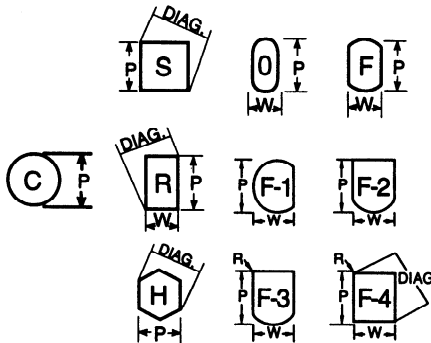
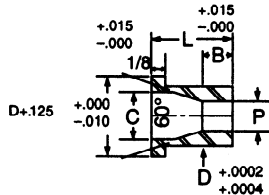

Guide Chart

Hole Range P/DIAG	Land Length B
Up to .0650	2P
.0651-.0950	P + .065
.0951-.4250	.80P + .080

UNIVERSAL CODE: 1131, 1132, 1133 (SEE PAGE 175)

Body		Round	Shape		C'Bore	Overall Length L				
D	Code	Range P	Min. W	Max. DIAG	Dia. C	.3125	.375	.500	.625	Code
.1875	18	.062-.130	.050	.130	.141	31				18
.2500	25	.062-.170	.050	.170	.201					25
.3125	31	.093-.212	.050	.212	.261		37			31
.3750	37	.125-.255	.050	.255	.323			50		37
.4375	43	.187-.297	.075	.297	.386				62	43
.5000	50	.212-.344	.075	.344	.488					50
.6250	62	.293-.425	.075	.425	-					62
.1875	18	.062-.130	.050	.130	.141	31				18
.2500	25	.062-.170	.050	.170	.201					25
.3125	31	.093-.212	.050	.212	.261		37			31
.3750	37	.125-.255	.050	.255	.323			50		37
.4375	43	.187-.297	.075	.297	.386				62	43
.5000	50	.212-.344	.075	.344	.488					50
.6250	62	.293-.425	.075	.425	-					62
.1875	18	.062-.130	.050	.130	.141	31				18
.2500	25	.062-.170	.050	.170	.201					25
.3125	31	.093-.212	.050	.212	.261		37			31
.3750	37	.125-.255	.050	.255	.323			50		37
.4375	43	.187-.297	.075	.297	.386				62	43
.5000	50	.212-.344	.075	.344	.488					50
.6250	62	.293-.425	.075	.425	-					62

**HOW TO ORDER**

STEEL SHAPE GUIDE WIRE PRESS-FIT BODY OVERALL "P" "W" TOLERANCE UNLESS SPECIFIED TOL. #1 WILL BE FURNISHED

**A O G W 50 - 62 X .250 X .062 TOL #2**