

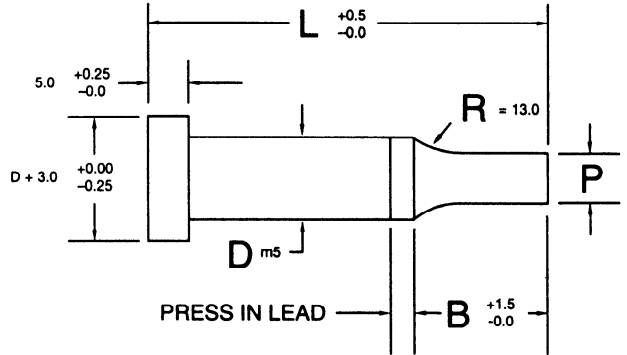

PIVOT PUNCH CORPORATION / BASIC SERIES METRIC
SOLID PUNCH

STEEL: M-2 R/C 60/62
HEADS DRAWN TO R/C 40-50

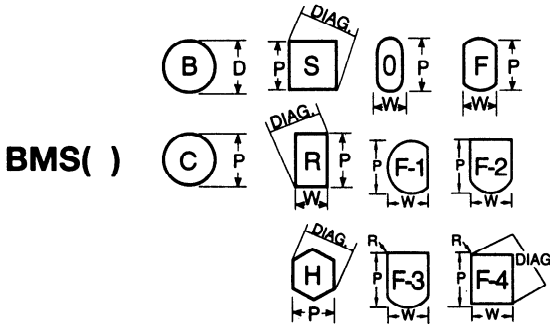

Basic

Round P	+0.01	T.I.R. = 0.01
	-0.00	
Shape P,W	±0.01	T.I.R. = 0.02

Shank D	Point Std.	Length B Alt.	Range P	Min. W	Min. W	Max P/G	Length = L									
							40	50	56	60	63	70	71	80	90	100
04	13	16	1.00-4.00	-	-	-	X	X	X	X	X	X	X	X	X	X
05	16	20	1.30-5.00	1.3	1.30-4.97	-	X	X	X	X	X	X	X	X	X	X
06	16	20	1.60-6.00	1.4	1.60-5.97	-	X	X	X	X	X	X	X	X	X	X
08	20	25	2.50-8.00	2.0	2.00-7.97	-	X	X	X	X	X	X	X	X	X	X
10	20	25	3.00-10.00	2.8	3.50-9.97	-		X	X	X	X	X	X	X	X	X
13	20	25	5.00-13.00	3.2	4.50-12.97	-		X	X	X	X	X	X	X	X	X
16	25	32	8.00-16.00	6.0	6.00-15.97	-		X	X	X	X	X	X	X	X	X
20	25	32	12.00-20.00	6.0	8.00-19.97	-			X	X	X	X	X	X	X	X
25	25	32	16.50-25.00	6.0	10.00-24.97	-			X	X	X	X	X	X	X	X
32	32	38	24.00-32.00	6.0	12.50-31.97	-				X	X	X	X	X	X	X

P,W Increments = 0.01

L=40, Max B=13
L=50, Max B=25

HOW TO ORDER

TYPE SHAPE DIA. CODE LENGTH "P" "W"

BMS 0 10 60 5.20 4.60