

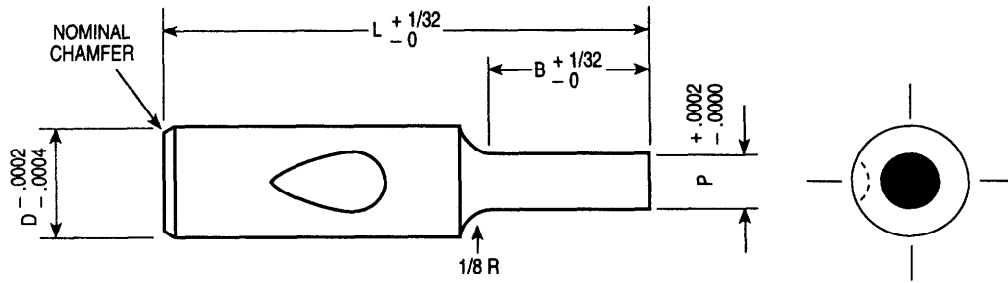

OBERG CARBIDE PUNCH & DIE / STANDARD TOLERANCE CARBIDE PUNCHES, BALL RETAINER TYPE - LIGHT DUTY



CONCENTRICITY .0002" T.I.R. POINT TO SHANK

CATALOG NUMBER	D DIAMETER	P POINT DIAMETER	B POINT LENGTH	L = LENGTH						
				2	2 1/4	2 1/2	2 3/4	3	3 1/4	3 1/2
1PB-25	.250	.060 - .090	3/8"
2PB-25	.250	.0901 - .125	3/8"
3PB-25	.250	.1251 - .250	3/8"
1PB-37	.375	.187 - .250	1/2"
2PB-37	.375	.2501 - .313	1/2"
3PB-37	.375	.3131 - .375	1/2"
1PB-50	.500	.250 - .325	5/8"
2PB-50	.500	.3251 - .400	5/8"
3PB-50	.500	.4001 - .500	5/8"

NOTE: ANY DIMENSION OTHER THAN THOSE SHOWN QUOTED ON REQUEST

WHEN ORDERING SPECIFY:

Quantity	Catalog Number	L	P
3	1PB-50	2 1/2"	.2630"

Note: Heavy duty available.

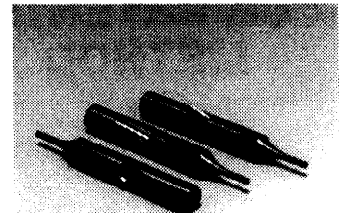

This catalog covers +.0002/+.0004" tolerance die components.
For +.00005/-.00000" tolerance die components, please refer to our precision catalog.