

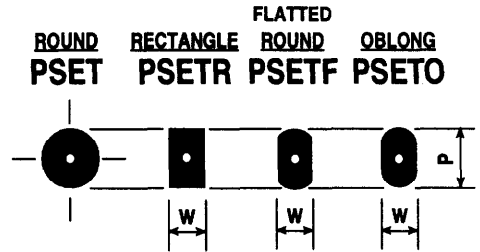

OBERG CARBIDE PUNCH & DIE / METRIC TOLERANCE CARBIDE PUNCHES WITH AIR HOLE AND MACHINABLE STEEL SLEEVE HEAD

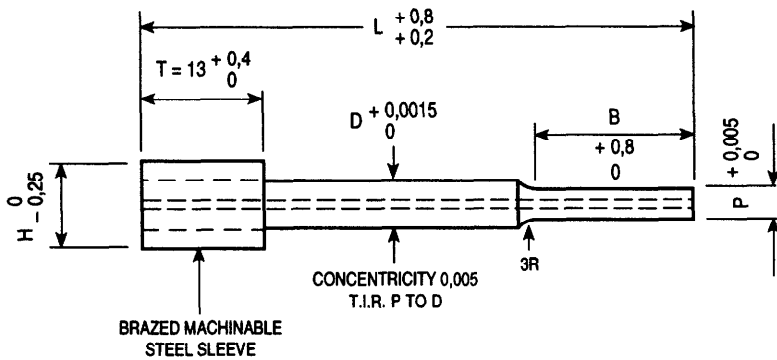

CATALOG NUMBER	D DIAMETER	P POINT DIAMETER	B POINT LENGTH	H HEAD DIAMETER	L = LENGTH						
					AIR HOLE DIA.	50	60	70	80	90	100
1PSET-5M	5,0	2,50 - 5,00	20	8,00	1,2	*	*	*	*	*	*
1PSET-6M	6,0	2,50 - 6,00	20	9,00	1,2	*	*	*	*	*	*
1PSET-8M	8,0	4,00 - 8,00	22	11,00	1,2	*	*	*	*	*	*
1PSET-10M	10,0	7,00 - 10,00	22	13,00	2,8	*	*	*	*	*	*
1PSET-13M	13,0	10,00 - 13,00	22	16,00	3,6	*	*	*	*	*	*
1PSET-16M	16,0	11,00 - 16,00	22	19,00	3,6	*	*	*	*	*	*
1PSET-20M	20,0	15,00 - 20,00	22	23,00	3,6	*	*	*	*	*	*

All outside corners to be sharp unless otherwise specified by customer.

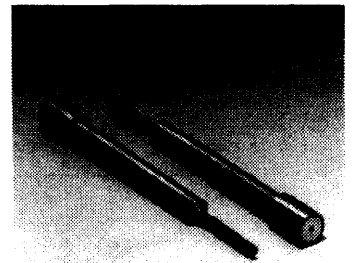

NOTE: ANY DIMENSION OTHER THAN THOSE SHOWN QUOTED ON REQUEST

WHEN ORDERING SPECIFY:

Quantity	Catalog Number	L	P
5	1PSET-5M	50	4,23

Quantity	Catalog Number	L	Point Dimensions
12	1PSETO-5M	50	W = 3,23 P = 4,23

POWER FEED CONTACTS

...for Wire EDM Machines

Agie
Brother
Charmilles
Fanuc
Hansvedt
Hitachi
Japax
Makino
Mitsubishi
Seibu
Sodick

Superior Quality ... Power Feed Contacts

The faster running speeds of today's wire EDM machines demand a superior Power Feed Contact. Now you can obtain Power Feed Contacts of unparalleled quality.

- Only those highest quality materials most conducive to consistent and extended wear life are utilized.
- All dimensions are finished ground to exact tolerances.
- All wear surfaces are polished for smoother wire movement.
- They're available immediately from stock.

And they're backed by Oberg's unconditional no-quibble guarantee:

Buy your first set of Oberg Power Feed Contacts. If for any reason you're not satisfied, return the set for a full refund of your purchase price.

You really can't lose!

If you would like data/price schedules covering your particular wire EDM machine(s), please contact us.