

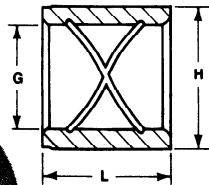

Lamina **STRAIGHT BUSHINGS**

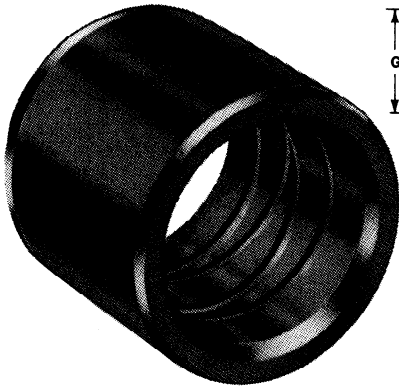

G (I.D.) +.0005 -.0000	L LENGTH	H O.D.	CATALOG NUMBER
.7505	7/8	1.1255	STB-06-07
	1-3/8	1.1255	STB-06-13
.8755	1-3/8	1.2505	STB-07-13
1.0005	1-3/8	1.3755	STB-08-13
1.2505	1-3/8	1.6255	STB-10-13
	1-7/8	1.6255	STB-10-17
1.5005	1-3/8	2.0005	STB-12-13
	1-7/8	2.0005	STB-12-17
2.0005	3-7/8	2.5005	STB-16-37
2.5005	4-7/8	3.2505	STB-20-47

Lamina **EJECTOR BUSHING** (Bronze Plated)

GENERAL DIMENSIONS

CAT. NO.	P +.0005 -.0000	B +.0005 -.0000	D +.0 -1/16	A +.0 -.010	C +.000 -.001	L +.000 -.030	H
ELB750	.751	1.1255	1.50	1.302	1.124	1.00	.56
ELB875	.876	1.2505	1.50	1.427	1.249	1.00	.56
ELB100	1.001	1.3755	1.75	1.552	1.374	1.12	.62
ELB125	1.251	1.6255	1.75	1.802	1.624	1.12	.62
ELB150	1.501	2.0005	1.75	2.177	1.999	1.12	.62

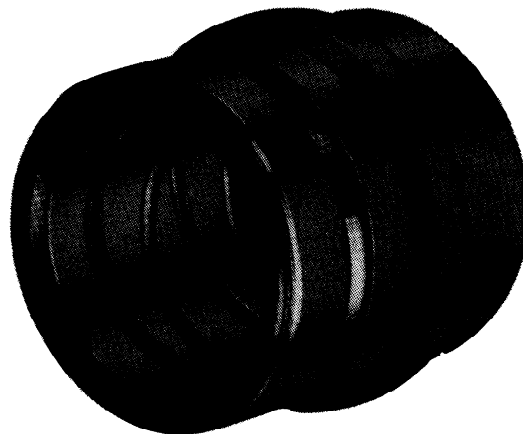
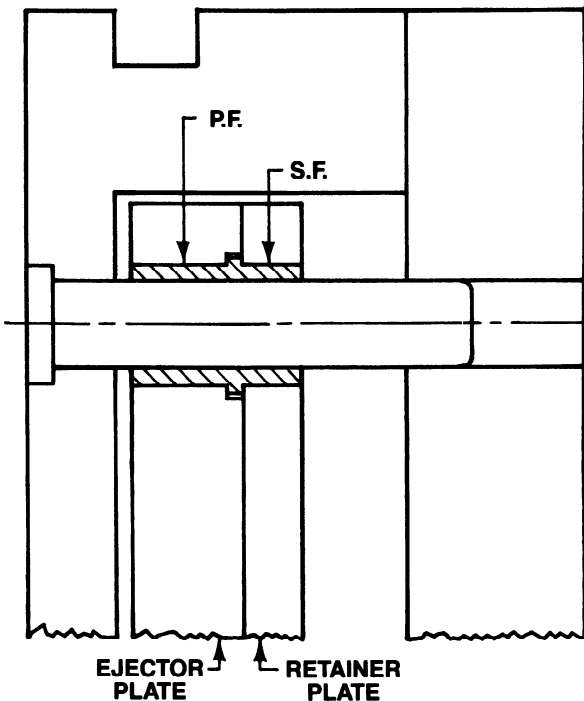
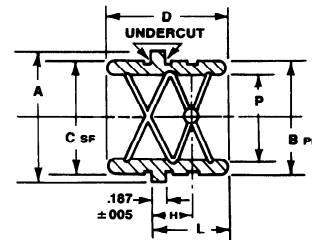

Lubrication Ring
P.F. Dia. Grd to Size
Opp. End Grd. For Ejector Plate Removal
Lubrication Hole
Lamina Bronze Plated I.D.
Radii to Serve as Lead
I.D. Oversize to Accommodate Expansion
Plating Thickness .004 - .005 per side

**OFFERS QUICK EASY INSTALLATION
ELIMINATES DOWELS**