

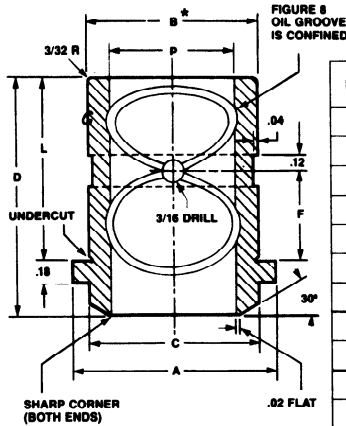

Bronze Plated on Hardened Steel GUIDE BAR BUSHINGS

Lamina

Wiper Clamp-Head Type

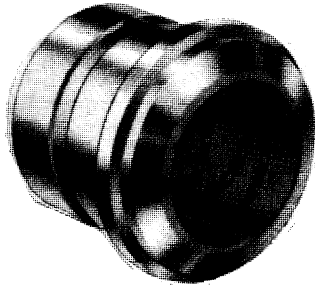
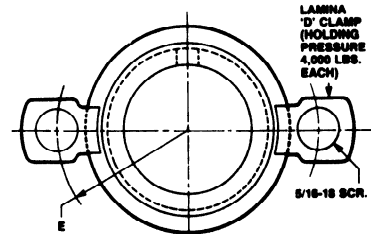

Bushings with assemblies include bushings, clamps and screws.
Specify Bushing Number and Assembly.

BUSHING (ASSEMBLY)
(Includes bushing, clamps, screws)

PART NO.	P	A	B*	C	D	E	F	L	NO. OF CLAMPS & SCREWS
LMB-062	.6255	1.12	1.000	.93	1.21	.76	.37	.76	2
LMB-075	.7505	1.31	1.125	1.12	1.23	.86	.37	.76	
LMB-087	.8755	1.56	1.250	1.37	1.50	.98	.49	1.00	3
LMB-100	1.0005	1.75	1.375	1.56	1.55	1.08	.49	1.00	
LMB-125	1.2505	2.12	1.750	1.93	1.94	1.26	.69	1.38	
LMB-150	1.5005	2.37	2.000	2.18	2.06	1.39	.75	1.50	4
LMB-175	1.7505	2.62	2.250	2.43	2.31	1.52	.88	1.75	
LMB-200	2.0005	2.93	2.500	2.75	2.57	1.67	1.00	2.00	6
LMB-250	2.5005	3.62	3.250	3.43	3.12	2.01	1.25	2.50	
LMB-300	3.0005	4.12	3.750	3.93	3.62	2.26	1.50	3.00	6
LMB-375	3.7505	4.87	4.500	4.68	4.37	2.63	1.87	3.75	
LMB-450	4.5005	5.87	5.500	5.68	5.20	3.14	2.25	4.50	

*"B" diameter (ring fit) available finished ground to nominal + .000
Specify Grind LDSS. - .0005

**"B" diameter also available with + .015 grindstock.
Specify with Grindstock.

SHORT SHOULDER TYPE

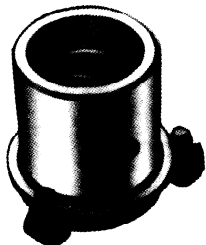

BRONZE PLATED

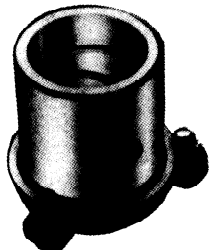

ALUMINUM BRONZE

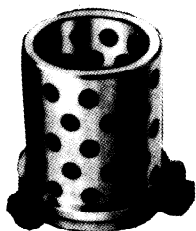

BRONZE SELF LUBE

P NOM. PIN DIA.	A	C	B*	D OVER ALL LENGTH	H HEAD LENGTH	L WIRING- FIT LENGTH	BRONZE PLATED PART NO.	ALUMI- N BRONZE PART NO.	** BRONZE SELF LUBE PART NO.	NO. OF CLAMPS & SCREWS	E
3/4	1-5/16	1-1/8	1.125	1-9/16	1/2	1-1/16	SC-750-S	SC-750-SB	OSG-750-S	2	55/64
				2-5/16	1/2	1-13/16	SC-750-L	SC-750-LB	OSG-750-L		
7/8	1-9/16	1-3/8	1.375	1-9/16	1/2	1-1/16	SC-875-S		OSG-875-S	2	63/64
				2-5/16	1/2	1-13/16	SC-875-L		OSG-875-L		
1	1-3/4	1-9/16	1.500	1-7/8	1/2	1-3/8	SC-100-S	SC-100-SB	OSG-100-S	3	1-5/64
				2-7/8	1/2	2-3/8	SC-100-L	SC-100-LB	OSG-100-L		
1-1/4	2-1/8	1-15/16	1.750	2-3/8	1/2	1-7/8	SC-125-S	SC-125-SB	OSG-125-S	3	1-17/64
				3-3/8	1/2	2-7/8	SC-125-L	SC-125-LB	OSG-125-L		
1-1/2	2-3/8	2-3/16	2.000	2-3/8	1/2	1-7/8	SC-150-S	SC-150-SB	OSG-150-S	3	1-25/64
				3-3/8	1/2	2-7/8	SC-150-L	SC-150-LB	OSG-150-L		
1-3/4	2-5/8	2-7/16	2.250	2-7/8	1/2	2-3/8	SC-175-S	SC-175-SB	OSG-175-S	3	1-33/64
				3-7/8	1/2	3-3/8	SC-175-L	SC-175-LB	OSG-175-L		
2	2-15/16	2-3/4	2.500	2-7/8	1/2	2-3/8	SC-200-S	SC-200-SB	OSG-200-S	4	1-43/64
				3-7/8	1/2	3-3/8	SC-200-L	SC-200-LB	OSG-200-L		
2-1/2	3-3/8	3-3/16	3.000	3	3/8	2-5/8	SC-250-S	SC-250-SB	OSG-250-S	4	1-57/64
				4	3/8	3-5/8	SC-250-M	SC-250-MB	OSG-250-M		
3	3-7/8	3-11/16	3.500	5	3/8	4-5/8	SC-250-L	SC-250-LB	OSG-250-L	6	2-9/64
				3	3/8	2-5/8			OSG-300-X		
3-3/4	4-7/8	4-11/16	4.500	4	3/8	3-5/8	SC-300-S	SC-300-SB	OSG-300-S	6	2-9/64
				5	3/8	4-5/8	SC-300-M	SC-300-MB	OSG-300-M		
4-1/2	5-7/8	5-11/16	5.500	8	3/8	7-5/8		SC-300-L	SC-300-LB	OSG-300-L	
4-1/2	5-7/8	5-11/16	5.500					SC-375-B	OSG-375	6	2-41/64
4-1/2	5-7/8	5-11/16	5.500					SC-450-B	OSG-450	6	3-9/64

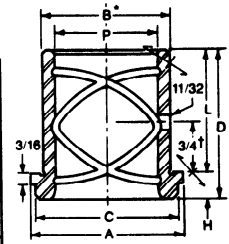

†Bushings of 2 1/2" diameter and larger, have 1 1/4" dimensions.

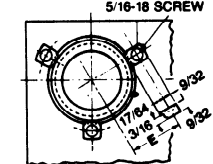

‡Aluminum Bronze, Centrifugally Cast (ASTM-B-148-9C).

BUSHINGS
LD. Substances

Pin Dia.	Part No.	Part No.
3/4	750	750S
	875	875S
	100	100S
7/8	125	125S
	150	150S
	175	175S
1	200	200S
	250	250S
	300	300S
1-1/4	300	300S
	350	350S
	400	400S
1-1/2	400	400S
	450	450S
	500	500S
1-3/4	500	500S
	550	550S
	600	600S
2	600	600S
	650	650S
	700	700S
2-1/2	700	700S
	750	750S
	800	800S
3	800	800S
	850	850S
	900	900S
3-1/4	900	900S
	950	950S
	1000	1000S
4-1/2	1000	1000S
	1050	1050S
	1100	1100S

*"B" diameter (ring fit) available finished ground to nominal + .000
Specify Grind LDSS. - .0005

**"B" diameter also available with + .015 grindstock.
Specify with Grindstock.

Bushings with assemblies include bushings, clamps and screws.
Specify Bushing Number and Assembly. ** Self Lube (OSG) bushings not available in Class 1.