

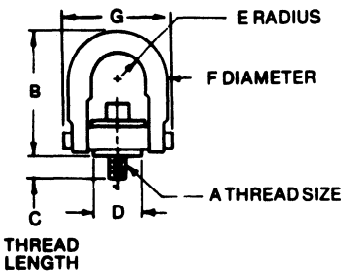

HOIST RINGS

Center-Pull Hoist Rings

Popular size hoist rings (1/2-13 through 1-8) are offered with two or more length bolts. Use the longer lengths with softer parent materials, the shorter lengths with hard materials such as steel.



- Cut handling time.
- Full swivel and pivot action.
- Stronger than eyebolts.
- Built to last.
- Rated at 5:1 strength factor.

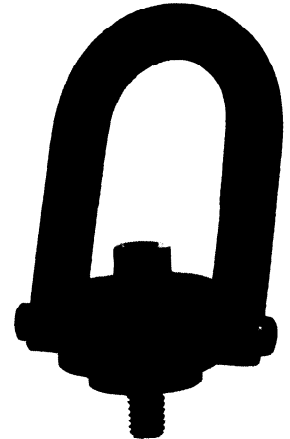

- Material: 4140
- Finish: Black Oxide
- Washer: Gold Iridite
- Clevis, Bolt, Pins, Base, Washer and Bushing are Magnetic Particle Inspected.

Center-Pull Hoist Rings

THREAD SIZE A	LOAD CAPACITY (lbs.)	STD. CLEVIS		LONG CLEVIS		THREAD LENGTH C	D	RADIUS E	DIA. F	G	TORQUE ¹ (lb. ft.)	WT. (lbs.)
		PART NUMBER	B	PART NUMBER	B							
1/8-18	800	23406	2.67	—	—	3/16	.75	.43	.38	1.84	7	.3
1/8-16	1000	23408	2.67	—	—	3/16	.75	.43	.38	1.84	12	.3
		23410	3.75	—	—	1/8	1.20	.69	.50	2.56	28	1.0
1/2-13	2500	23411	4.78	23511	6.72	3/4	1.50	.88	.75	3.52	28	2.5
		23412	4.78	23512	6.72	1	1.50	.88	.75	3.52	28	2.5
		23413	4.78	23513	6.72	1 1/4	1.50	.88	.75	3.52	28	2.5
		23414	4.78	23514	6.72	1	1.50	.88	.75	3.52	60	2.7
3/8-11	4000	23415	4.78	23515	6.72	1 1/4	1.50	.88	.75	3.52	60	2.7
		23417	4.78	23517	6.72	1	1.50	.88	.75	3.52	100	3.0
3/4-10	5000	23418	4.78	23518	6.72	1 1/2	1.50	.88	.75	3.52	100	3.0
		23420	6.52	23520	8.11	1	2.31	1.40	1.00	5.14	100	7.0
3/4-10	7000	23421	6.52	23521	8.11	1 1/2	2.31	1.40	1.00	5.14	100	7.0
		23423	6.52	23523	8.11	1	2.31	1.40	1.00	5.14	160	7.0
3/8-9	8000	23424	6.52	23524	8.11	1 1/4	2.31	1.40	1.00	5.14	160	7.0
		23425	6.52	23525	8.11	1 1/4	2.31	1.40	1.00	5.14	230	7.5
1-8	10000	23426	6.52	23526	8.11	1 1/2	2.31	1.40	1.00	5.14	230	7.5
		23427	6.52	23527	8.11	2 1/4	2.31	1.40	1.00	5.14	230	7.5
		23429	8.73	—	—	—	1 1/4	3.19	1.75	1.25	6.50	470
1 1/2-6	24000	23433	12.47	—	—	2 3/4	4.19	2.25	1.75	8.55	800	33
2-4 1/2	30000	23435	12.47	—	—	3 3/8	4.19	2.25	1.75	8.55	800	36

Bolt Kit ★

PART NUMBER	WT. (lbs.)
23606	.03
23608	.05
23610	.16
23611	.14
23612	.16
23613	.17
23614	.27
23615	.29
23617	.40
23618	.46
23620	.46
23621	.52
23623	.62
23624	.66
23625	.92
23626	.97
23627	1.13
23629	2.90
23633	3.50
23635	7.3

¹ Stated load capacity based on specific thread torques as shown in chart.

² It is recommended that these torques be used when installing hoist rings.

★ Bolt Kit contains bolt and retaining ring.