



# Vlier

## SERIES K CUPMOUNTS

**PROTECT SENSITIVE EQUIPMENT FROM SEVERE SHOCK AND HIGH FREQUENCY VIBRATION**

These versatile, fail-safe mounts combine protection against severe impact shock with efficient vibration isolation. They can be mounted in any orientation for protection of sensitive electronic, electrical and mechanical equipment from high impact shocks.

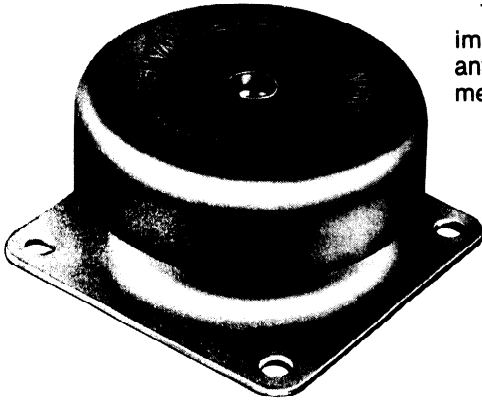

**BENEFITS**

- Mount In Any Orientation
- Reduce Installation Cost
- No Special Foundation
- Maximum Mobility
- Reduce Maintenance Costs
- Improve Production Efficiency
- Reduce Noise Levels
- Isolate Shock & Vibration
- Meets OSHA Anchoring Standards

**FEATURES**

- Captive, Fail Safe Construction
- Cold Rolled Steel
- Zinc Chromate Plated Casing
- Operating Temperature Range of -65°F to 180°F
- Oil Immersion Resistant
- High Vibration Dampening Elastomer

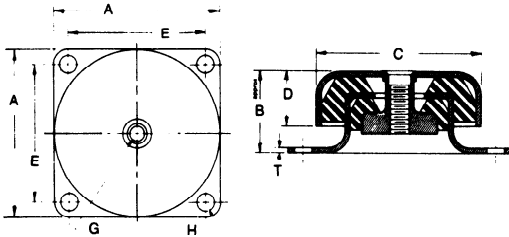

Cross-Section Detail Varies with Series.

**APPLICATIONS**

- Motors
- Pumps
- Numerical Control Equipment
- Fans
- Blowers
- Transformers
- Centrifuges
- Control Panels
- Electronic, Electrical and Mechanical Equipment.

**INDUSTRIAL CUPMOUNTS**

PART NO.	LOAD RANGE (lbs)
<b>SERIES K1000</b>	
K1010	10-20
K1015	20-40
K1035	35-70
K1050	70-140
<b>SERIES K2000</b>	
K2020	20-50
K2040	30-100
K2060	50-150
K2090	90-250
<b>SERIES K3000</b>	
K3125	100-400
K3175	150-600
K3300	200-850
K3500	400-1800
<b>SERIES K4000</b>	
K4100	80-250
K4135	140-400
K4200	200-600
K4300	250-900

SERIES	APPROX WEIGHT	A	B	C	D	E	G	H	T	DYNAMIC STIFFNESS HORIZONTAL : VERTICAL
K1000	6 OZ	2 <sup>3</sup> / <sub>8</sub>	1 <sup>1</sup> / <sub>8</sub>	2 <sup>9</sup> / <sub>32</sub>	1 <sup>1</sup> / <sub>16</sub>	1 <sup>15</sup> / <sub>16</sub>	1/4-20 THRU	.196	1/16	.8 APPROX
K2000	1 LB	3	1 <sup>1</sup> / <sub>2</sub>	3	1	2 <sup>1</sup> / <sub>2</sub>	3/8-16 THRU	.266	3/32	.9 APPROX
K4000	4 LB	5 <sup>1</sup> / <sub>4</sub>	2 <sup>1</sup> / <sub>2</sub>	4 <sup>7</sup> / <sub>8</sub>	1 <sup>1</sup> / <sub>2</sub>	4 <sup>1</sup> / <sub>4</sub>	5/8-11 x 7/8	15/32	1/8	.9 APPROX
K3000	10 LB	6 <sup>7</sup> / <sub>8</sub>	3 <sup>9</sup> / <sub>16</sub>	6 <sup>5</sup> / <sub>8</sub>	2 <sup>5</sup> / <sub>16</sub>	5 <sup>5</sup> / <sub>8</sub>	5/8-11 x 1 3/8	17/32	3/16	1.0 APPROX

**APPLICATION PERFORMANCE**

**SERIES K1000 & K2000**

